

Premium Softcube - Quadrant

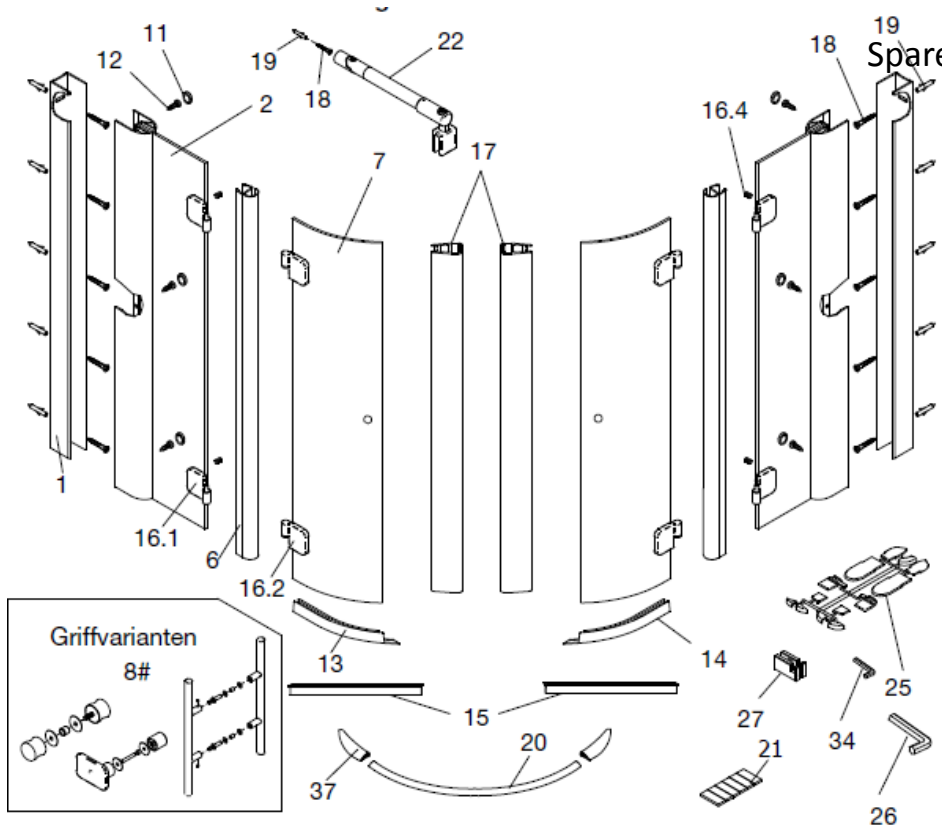

Spare Part Request Form – Fax Back to 01283 584994

HSK - SPARE PART - Request Form



- | | | | |
|------|---|----|---|
| Pos. | | | |
| 1 | 2 x wall connection profile | 17 | 2 x magnet |
| 2 | 2 x side panel with holes | 18 | 10 x countersunk head screw 4,2 x 45 mm |
| 6 | 2 x sealing profile vertical | 19 | 10 x dowel S6 |
| 7 | 2 x door | 20 | 1 x aluminum sealing profile |
| 8 | 2 x handle complete | 21 | 1 x adhesive stripes |
| 11 | 6 x cap for countersunk head screw | 25 | 1 x shield range |
| 12 | 6 x countersunk head screw 3,5 x 9,5 mm | 26 | 1 x hexagonal wrench SW 4 |
| 13 | 1 x water-repellent profile left | 27 | 4 x assembly aid 1 |
| 14 | 1 x Wasserabweisprofil right | 34 | 1 x hexagonal wrench SW 2 |
| 15 | 2 x pull-in sealing | 37 | 2 x cap 180° right/left |
| 16 | 4 x complete hinge | | |
| 16.1 | 4 x part of the hinge for fixed panel | | |
| 16.2 | 4 x part of the hinge for the door | | |
| 16.4 | 4 x fixing screw M3 x 3 mm | | |

Ref No. -	Date -
-----------	--------

CUSTOMER DETAILS

Customer		Retailer	
Name		Name	
Address		Address	
Post Code		Post Code	
Contact No.		Contact No.	

PRODUCT DETAILS

Product		Product No.	
Part No's			
Req'd			
Inst. Instr. No.			

OFFICE INFORMATION ONLY

Chargeable?	Inv. No.
Sent Via	Sent Date
HSK Conf. No.	Conf. Date
UK Stock Qty	Order Ref