

Imperial – Quadrant, 2 door

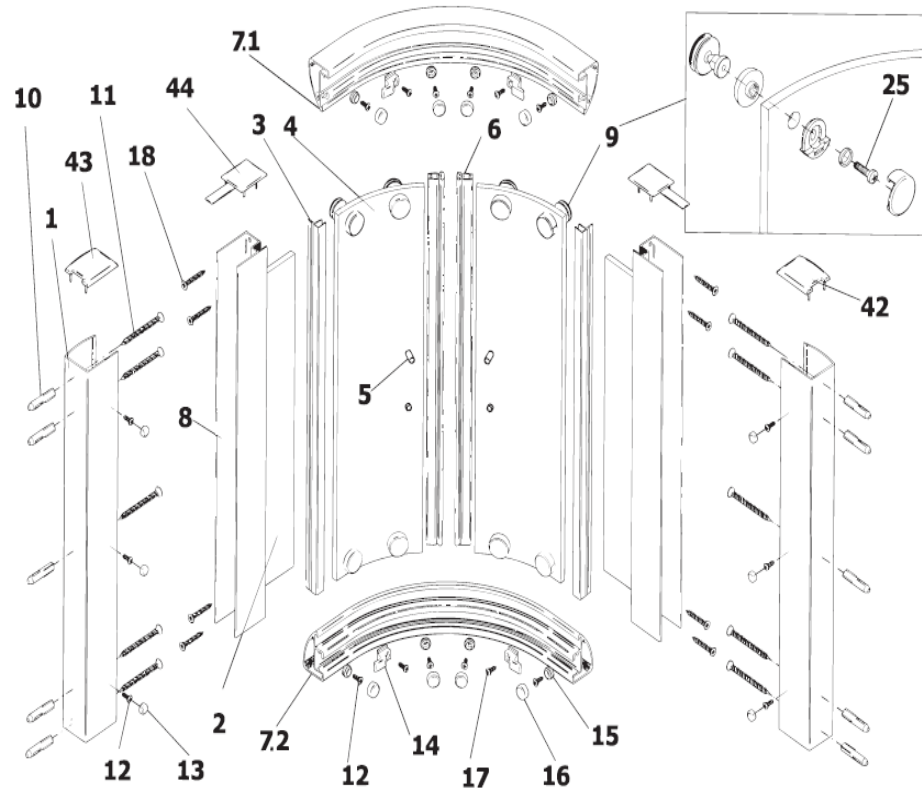

Spare Part Request Form – Fax Back to 01283 584994

HSK - SPARE PART - Request Form



Ref No. -	Date -
-----------	--------

CUSTOMER DETAILS

Customer		Retailer	
Name		Name	
Address		Address	
Post Code		Post Code	
Contact No.		Contact No.	

PRODUCT DETAILS

Product	Product No.
Part No's Req'd	
Inst. Instr. No.	

- | | | | |
|------|---|----|--|
| Pos. | | | |
| 1 | 2 x wall connection profile | 12 | 14 x Countersunk-head screw 3,5 x 9,5 mm |
| 2 | 2 x side panel left/right | 13 | 6 x caps |
| 3 | 2 x sealing profile vertical | 14 | 4 x hook |
| 4 | 2 x door left/right | 15 | 8 x contact cap |
| 5 | 2 x handle complete | 16 | 8 x caps |
| 6 | 2 x magnetic strip | 17 | 4 x Countersunk-head screw 2,9 x 9,5 mm |
| 7.1 | 1 x upper frame profiles | 18 | 8 x tapping screw 3,5 x 45 mm |
| 7.2 | 1 x lower frame profiles | 25 | 8 x flat-headed screw M4 x 16 mm |
| 8 | 2 x side panel profile | 42 | 1 x cap left |
| 9 | 8 x castors complete | 43 | 1 x cap right |
| 10 | 10 x dowel | 44 | 2 x pull-in cover button |
| 11 | 10 x Countersunk-head screw 4,2 x 32 mm | | |

OFFICE INFORMATION ONLY

Chargeable?	Inv. No.
Sent Via	Sent Date
HSK Conf. No.	Conf. Date
UK Stock Qty	Order Ref