

Style – Saloon Door & Side Panel

Spare Part Request Form – Fax Back to 01283 584994

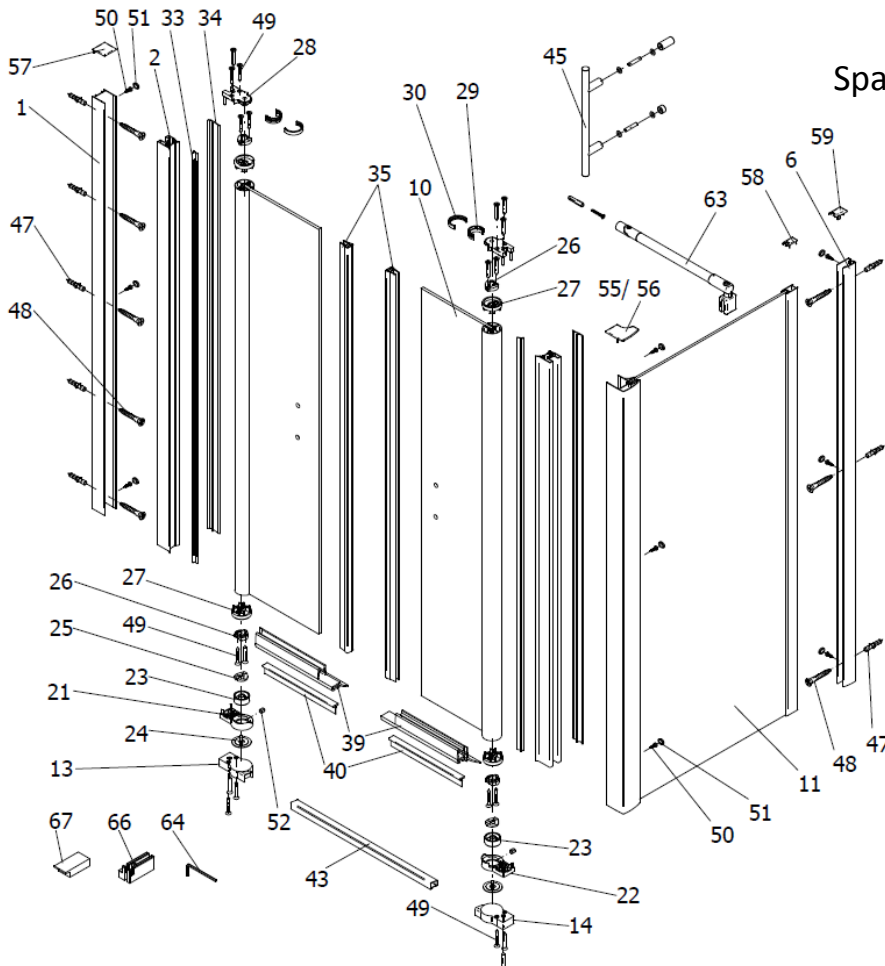

HSK - SPARE PART - Request Form



Pos.

- | | | | |
|----|--------------------------------------|-----|---|
| 1 | 1 x wall connection profile | 39 | 2 x water-repellent profile |
| 2 | 2 x side panel with profile | 40 | 2 x pull-in sealing |
| 6 | 1 x wall connection profile for SW | 43 | 1 x aluminum sealing profile |
| 10 | 2 x door | 45 | 2 x door handle |
| 11 | 1 x side panel | 47* | 8 x dowel Tri 6/36 |
| 13 | 1 x support for drip strip left | 48* | 8 x raised countersunk tapping screw 4,2 x 45 mm |
| 14 | 1 x support for drip strip right | 49* | 20 x raised countersunk tapping screw 3,5 x 25 mm |
| 21 | 1 x pivot bearing left | 50* | 9 x tapping screw 3,5 x 9,5 mm |
| 22 | 1 x pivot bearing right | 51* | 9 x cap |
| 23 | 2 x support for bend | 52* | 2 x stud M5 x 6 mm |
| 24 | 2 x attachment | 55 | 1 x cap left |
| 25 | 2 x bend | 56 | 1 x cap, right |
| 26 | 4 x curve part top | 57 | 1 x Top cap |
| 27 | 4 x pivot bearing-cover top Ø 36 mm | 58 | 1 x pull-in cover button |
| 28 | 2 x lower part of pivot bearing | 59 | 1 x cover cap |
| 29 | 2 x inside cover | 63 | 1 x aluminum sealing profile top |
| 30 | 2 x outside cover | 64* | 1 x hexagonal wrench SW 2,5 |
| 33 | 2 x inner sealing | 66* | 2 x assembly aid |
| 34 | 2 x sealing outwards | 67* | 2 x assembly aid |
| 35 | 2 x door sealing profile with magnet | | |

Ref No. -	Date -
-----------	--------

CUSTOMER DETAILS

Customer		Retailer	
Name		Name	
Address		Address	
Post Code		Post Code	
Contact No.		Contact No.	

PRODUCT DETAILS

Product		Product No.	
Part No's Req'd			
Inst. Instr. No.			

OFFICE INFORMATION ONLY

Chargeable?	Inv. No.
Sent Via	Sent Date
HSK Conf. No.	Conf. Date
UK Stock Qty	Order Ref